

**PRIMA**™  
FIBRE CEMENT BUILDING SOLUTIONS

International

**PRÎMACTU**™

  
SAINT-GOBAIN

## Features



# PRIMA CTU™

## Ceramic Tile Underlay

Ideal ceramic tiles laying substrate Ceramic Tile Underlay

**PRIMA CTU** is a premium quality autoclaved cellulose fibre reinforced cement board manufactured from Portland cement, top grade quality pulp from New Zealand, finely ground sand and water. Saint-Gobain Prima Sdn Bhd, a manufacturing plant that is accredited by MS ISO 9001:2000.

**PRIMA CTU** has superior fire performance and dimensional stability, which makes it an ideal substrate for ceramic tiles in wet and dry areas.

Manufactured with a pre-marked nailing pattern, sheets can be easily laid on existing timber flooring with minimal surface preparation.

### Product Features & Benefits

- Water Resistant
- Termite Resistant
- Fire Resistant
- Fungus Resistant
- Impact Resistant
- Good Workability
- Structurally Strong
- Reduces tile movements.
- Flat surface for smooth ceramic tile finishing.
- Pre-printed fastener points for ease of installation.
- Square cut edges for neat sheet jointing.
- Fibre cement superiority with lasting durability.
- Simple and easy installation.
- No stripping of old floor boards.
- Applicable in wet and dry areas.
- Less cutting and joining for large/wider areas.

## Standard Sizes

**PRIMA CTU™** standard thickness is 6.0mm.  
Its mass at EMC is approximately 8.8kg/m<sup>2</sup>

| Thickness (mm) | Width (mm) | Length (mm) |
|----------------|------------|-------------|
| 6.0            | 900        | 1800        |
|                | 1200       | 1800        |

Note: Other sizes are available on special order and may be subject to special conditions.



## Handling & Finishing

**PRIMA CTU™** should be overlaid with ceramic, mosaic or marble tiles. Use a compatible flexible tile adhesive. Ensure the sheet surface is free from dust or other contaminants prior to tiling. Refer to your tile adhesive manufacturer for more details.

### Underfloor Preparation Ventilation

Ensure that the underside of the existing floor is adequately ventilated and free from dampness.

### Existing Floorboards

Check and replace any damaged floorboards and firmly r nail any loose boards. The surface must be reasonably flat. Rough-sand any undulation prior to fixing the ceramic tile underlay

## Installation Steps

## Handling & Finishing

### Step 1

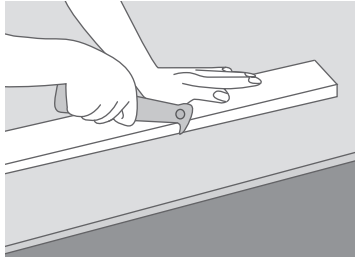

Cut the **PRIMA CTU™** using a "score and snap" knife. Use a straight edge as a guide while scoring a minimum of 1/3 of sheet thickness.

### Step 2

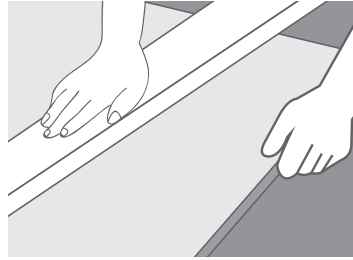

Hold the sheet firmly near the cut, while snapping the off-cut upward to break.

### Step 3

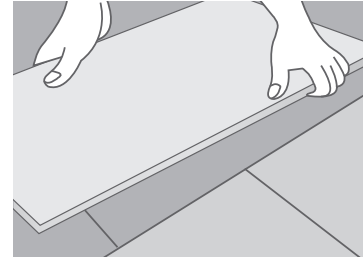

Lay **PRIMA CTU™** across the floorboard direction in a staggered (brick) pattern. Sheet joints must not coincide with floorboard joints (provide a minimum of 100mm offset). Allow a minimum of 3mm gap between sheet edges and walls.

### Step 4

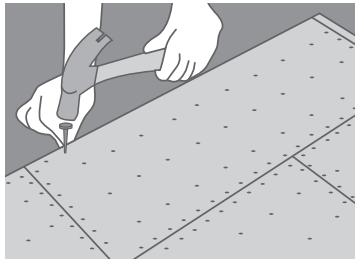

Fasten **PRIMA CTU™** from centre and working outwards using the pre-printed nailing pattern. Use 25mm x 2.5mmØ underlay nails. Drive nails flush with sheet surface.

### Step 5

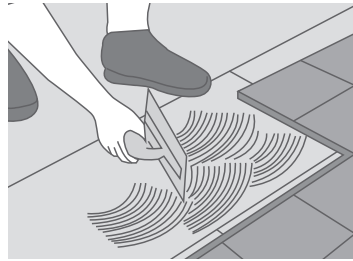

Apply tile adhesive onto **PRIMA CTU™** using a notched trowel. Refer to adhesive manufacturer's instructions.

### Step 6

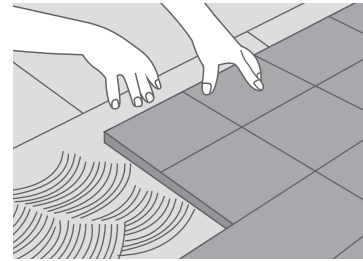

Lay ceramic tiles in accordance with tile manufacturer's recommendations.

## Sheet Fixing Illustrations



**PRIMA CTU™** can be fixed directly to existing timber, particleboard or plywood floor. Ensure that the existing floorboard is flat and in good condition prior to fixing the underlay sheet. Fasten underlay sheets at the pre-marked fixing positions. Underlay sheets should be laid in staggered or brick pattern.

## Sheet Layout

**PRIMA CTU™** sheets should be laid in a staggered or brick pattern, across the direction of floorboards. Sheet joints must not coincide with floorboard joints as shown in Figure 1.

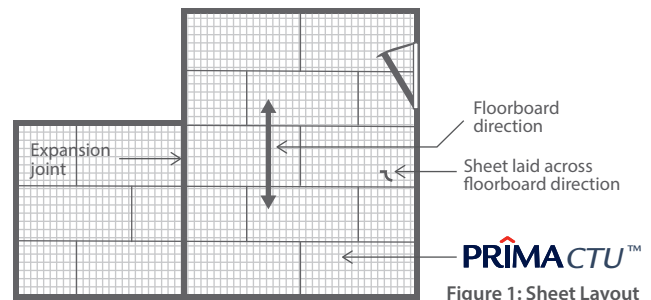

## Perimeter Expansion Gap

Leave a 3mm gap between sheet edges and wall at the wall-to-floor junction as shown in Figure 2.

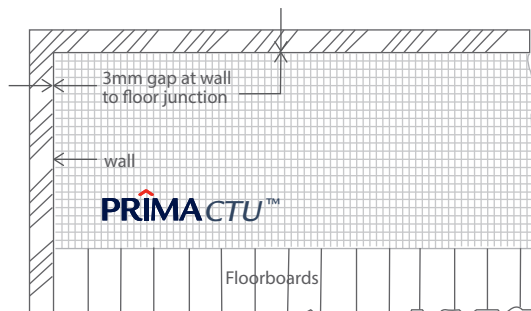

Figure 2: Perimeter Expansion Gap

## Fastener Specification

Use 25mm x 2.5mmØ annular threaded underlay nails. Nail fixing locations must be as the following:

- 12mm minimum from sheet edge
- 50mm minimum from corner
- 75mm maximum centres at perimeter
- 150mm maximum centres elsewhere

Drive nail heads flush with the underlay sheet surface. Commence nailing from the sheet centre and work outwards towards the sides and ends of sheet. Refer to Figure 3.

Note: For fixing to particleboard or plywood floor, apply wallboard adhesive to the rear of sheet with a 3mm notched trowel in addition to nail fixing as specified above.

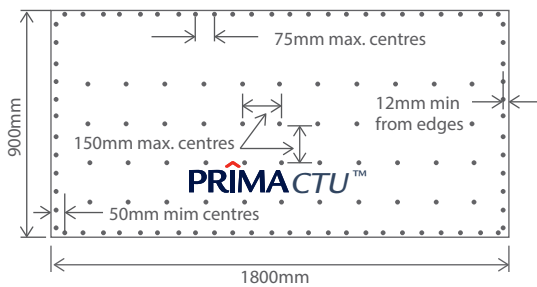

Figure 3: Fixing Locations

## Expansion Joints

Expansion joints must be provided at 5.0m maximum centres and must always coincide with the structural break joints of the existing floor structure. Refer to Figure 4.

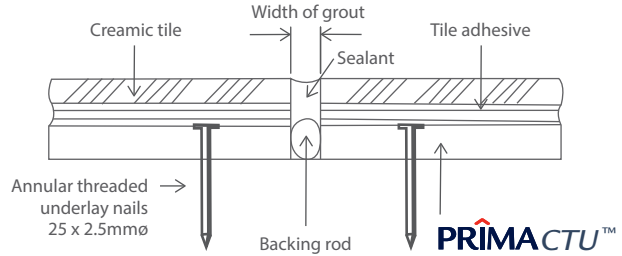

Figure 4: Detail at Expansion Joint

## Tile Adhesive & Grout

Use only flexible tile adhesive which comply to AS 2358 - Adhesive for fixing ceramic tiles. Refer to tile adhesive manufacturer for recommendations. Grouting material must be fully compressible.

## Tiling

Tiles should be laid in accordance with acceptable tile laying practice. Provide a minimum of 2mm to 3mm gap between each tile.

AS/NZS  
2908.2

ASTM  
C1186

Fire Resistance  
AS 1530.3

Termite Resistance -  
tested by CSIRO



Termite Resistant



Fire Resistant



Water Resistant



Weather Resistant



Environmentally  
Friendly



Superior Paint  
Adhesion



High Workability



Aesthetically  
Pleasing



50 Years  
Durability

For more information, please contact us at:



SAINT-GOBAIN PRIMA SDN BHD (579898-W)

Level 19, Tower 5, Avenue 7 The Horizon,  
Bangsar South City, No. 8, Jalan Kerinchi,  
59200 Kuala Lumpur, Malaysia

General Line 1: +603 7781 1977 | General Line 2: +6012 781 1797

[www.primafibreceement.com](http://www.primafibreceement.com) | [www.saint-gobain.my](http://www.saint-gobain.my)

[f](#) [in](#) [o](#) [@](#) [d](#) saintgobainprima